

Cor-80 Industrial System with thermal break

A new concept of a Euro-Groove hinged system capable of reaching the maximum levels of weather tightness, energy saving and acoustic protection with reduced assembly and fabrication time.

With 80 mm of frame depth, it responds to the most severe climatic demands, and provides an unbeatable degree of energy efficiency thanks to its minimal window transmission value (UH) that can reach $0.8 \text{ W/m}^2\text{K}$. These minimum values are achieved thanks to the perfect design of the thermal break zone with 45 mm tubular polyamide strips as well as the incorporation of cross-linked polyolefin both in the glazing space as well as the interior of the frame and sash.

Its great glazing capacity of up to 65 mm allows for the use of energy efficient glazing and compositions of large thicknesses as well as double chambers that gives excellent thermal and acoustic performance (up to 46 dB of noise protection) that translates in to maximum energy saving and total interior comfort.

The performance achieved in the AEV test, has shown this window to have the best water tightness performance, air permeability and wind resistance in order to guarantee the greatest protection against the most adverse atmospheric agents.

The simplicity in its assembly and less labour time, allows for a more industrialized fabrication resulting in a final saving of time and cost.



Cor-80 Industrial System with thermal break

Transmittance

Uw from 0,8 (W/m²K)

Please consult typology, dimensions and glass

Acoustic insulation

Maximum glazing: 65 mm.

Maximum acoustic insulation **Rw=46 dBA**

Finishes

Possibility of dual colour

Colour powder coating (RAL, mottled and rough)

Wood effect powder coating

Anti-bacterial powder coating

Anodized

Categories achieved at test centre

Air permeability
(EN 12207:2000): Class 4

Water tightness
(EN 12208:2000): Class E1950

Wind resistance
(EN 12210:2000): Class C5
Reference test 1,23 x 1,48 m. 2 sashes

Possibility of incorporating hardware with concealed hinges.

Possibility of incorporating security hardware
Evo Security.



Sections

Frame 80 mm.

Sash 88 mm.

Profile thickness

Window 1,5 mm.

Door 1,7 mm.

Polyamide strip length 45 mm.

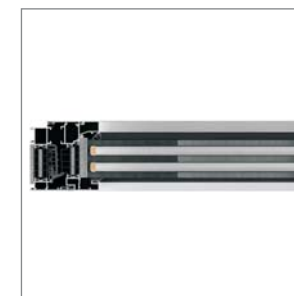
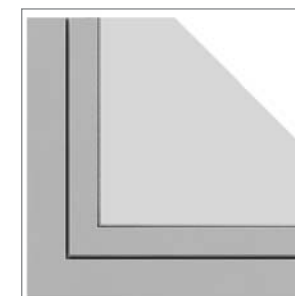
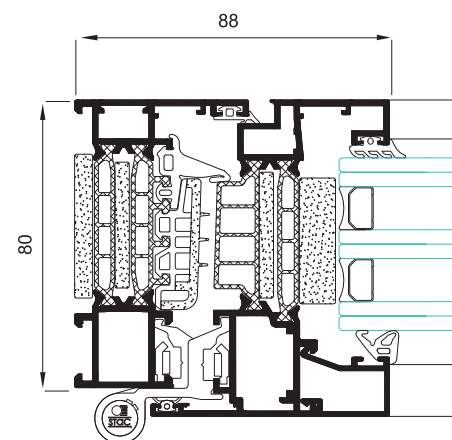

Opening possibilities



Open in: practicable, turn-tilt
parallel tilt, hinged.

Maximum dimensions/sash

Width (L) = 1.600 mm.

Height (H) = 2.600 mm.

Please consult regarding maximum weight and dimensions according to types

Maximum weight/sash

120 Kg.