

Cor-Urban CC System with thermal break

A hinged hidden double sash 122 mm system that allows for quadruple glazing facilitating a total acoustic silence and an optimum thermal insulation.

There is the possibility of incorporating a manual or motorized venetian blind or shutter in the internal (65 mm) chamber. Also access to the chamber is possible for cleaning and maintenance.

Additionally there is a quadruple gasket system that improves the thermal and acoustic insulation



Cor-Urban CC System with thermal break

Transmittance

Uw from 1,2 (W/m²K)

Please consult typology, dimensions and glass

Acoustic insulation

Maximum glazing:

-external sash 22 mm.

-internal sash 30 mm.

Maximum acoustic insulation **Rw=50 dBA**

Finishes

Possibility of dual colour

Colour powder coating (RAL, mottled and rough)

Wood effect powder coating

Anti-bacterial powder coating

Anodized

Categories achieved at test centre

Air permeability
(EN 12207:2000): Class 4

Water tightness
(EN 12208:2000): Class E1650

Wind resistance
(EN 12210:2000): Class C5
Reference test 1,23 x 1,48 m. 1 sash



Sections

Frame 122 mm.
Sash 121 mm.

Profile thickness

Window 1,6 mm.

Polyamide strip length

Frame 35 mm. Sash 20 mm.

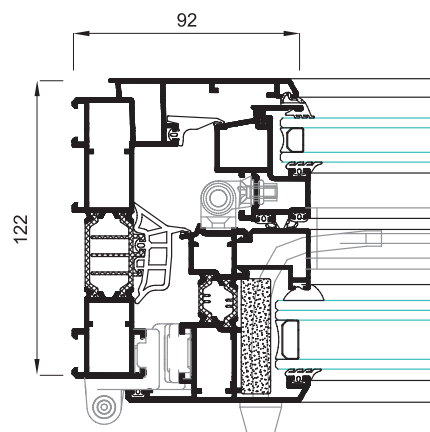

Opening possibilities



Open in:

- practicable 1 or 2 sashes
- turn-tilt 1 or 2 sashes

Maximum dimensions/sash

Width (L) = 1.400 mm.
Height (H) = 1.700 mm.

Please consult regarding maximum weight and dimensions according to types

Maximum weight/sash

150 Kg.